

Cover, Intermediate Shaft, Replace

1. Illustration of cover,
intermediate shaft

1. Intermediate
shaft cover
2. Fluid spout

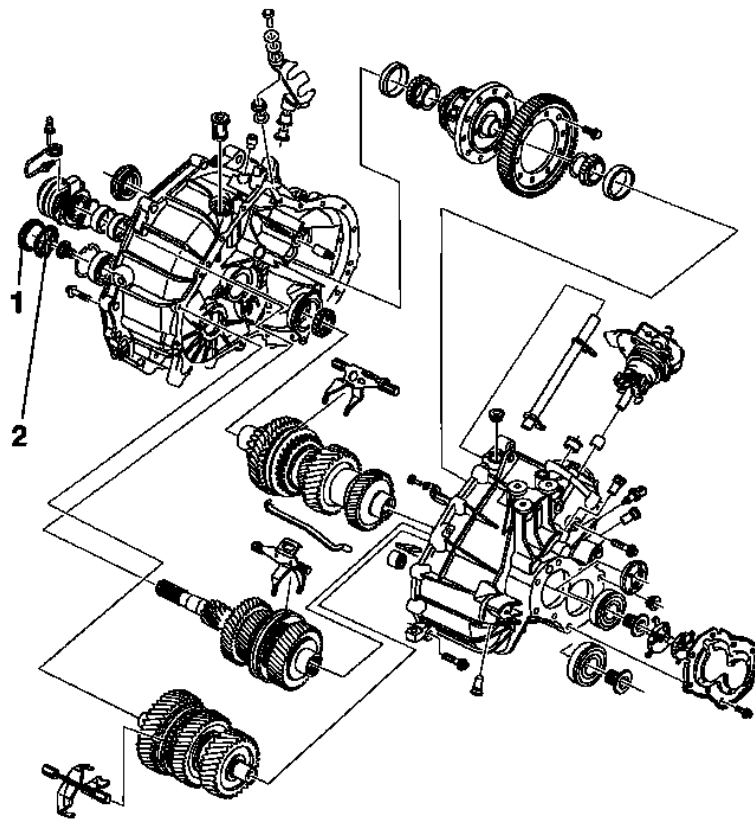

L 2547

2. Remove transmission from vehicle - see operation "Transmission, Remove and Install"
3. Install **KM-6115** (3) to
transmission (4)
4. Install **KM-6115** (5)
with transmission to
KM-113-2 (2)

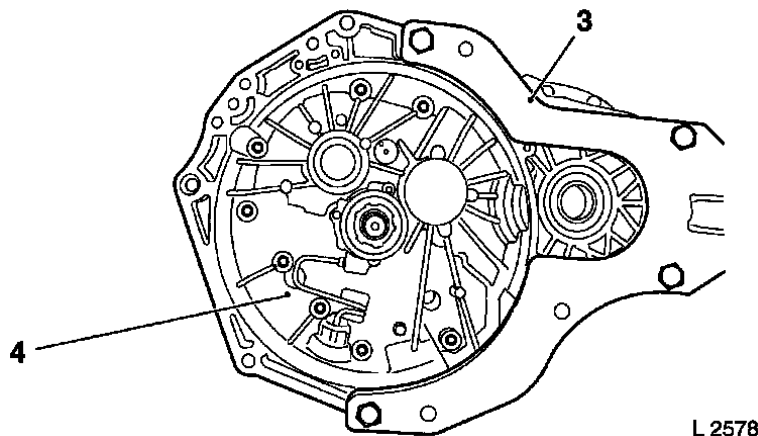
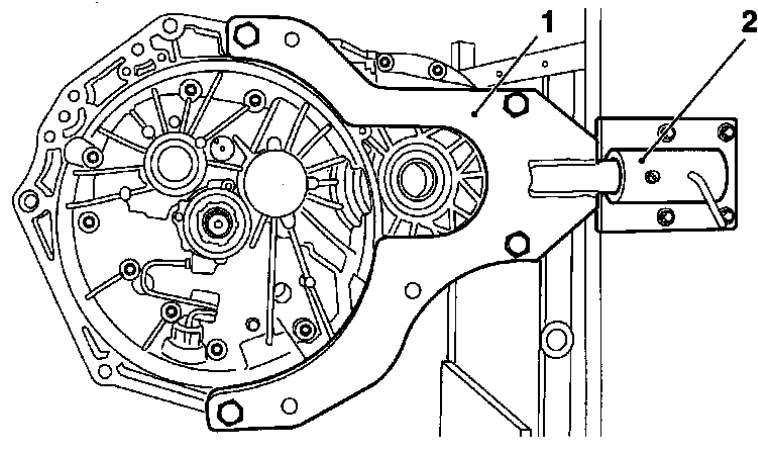

L 2578

5. Drive a hole (3) through the centre of intermediate shaft cover (2) using suitable drift (1)
6. Drive **KM-6101** (4) in conjunction with **KM-328-B** (5) flush with intermediate shaft cover
7. Drive intermediate shaft cover from transmission

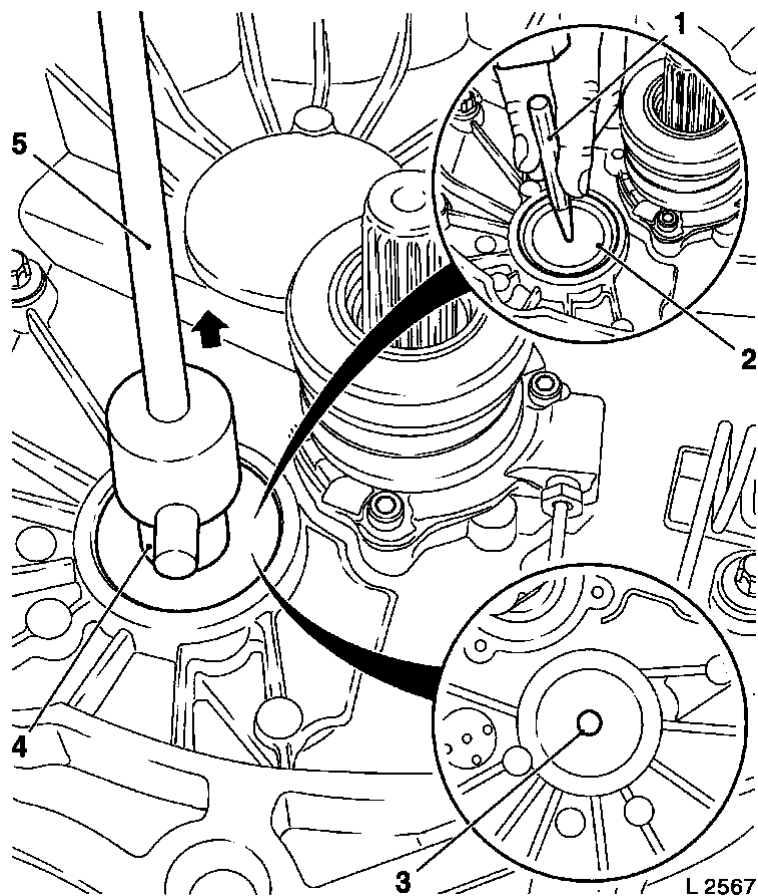

L 2567

8. Remove fluid spout

from transmission

9. Clean all parts
10. Check condition of fluid spout, replace if necessary
11. Install fluid spout (4) to transmission
12. Drive intermediate shaft cover (3) flush with transmission using **KM-6102** (2) in conjunction with **KM-523-1** (1)

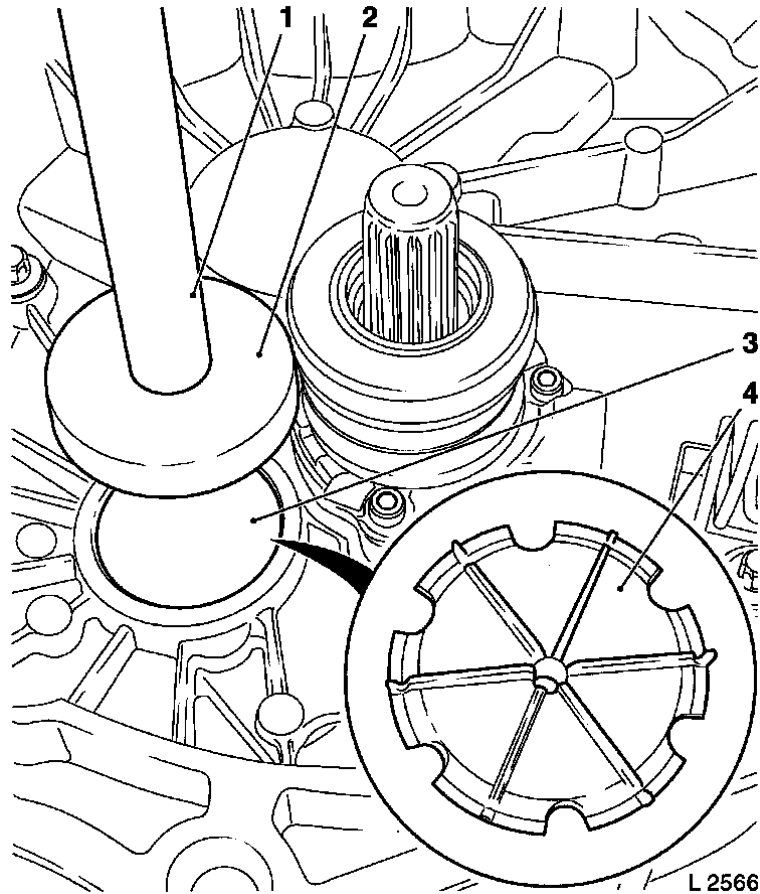

13. Remove **KM-6115** with transmission from **KM-113-2**
14. Remove **KM-6115** from transmission
15. Install transmission - see operation "Transmission, Remove and Install"